



UNI-WIFI

A GUIDE TO CONNECTING TO UNI-WIFI ON ANDROID PHONES

UNI-WIFI ON ANDROID PHONE

- First, select **Settings** from the menu

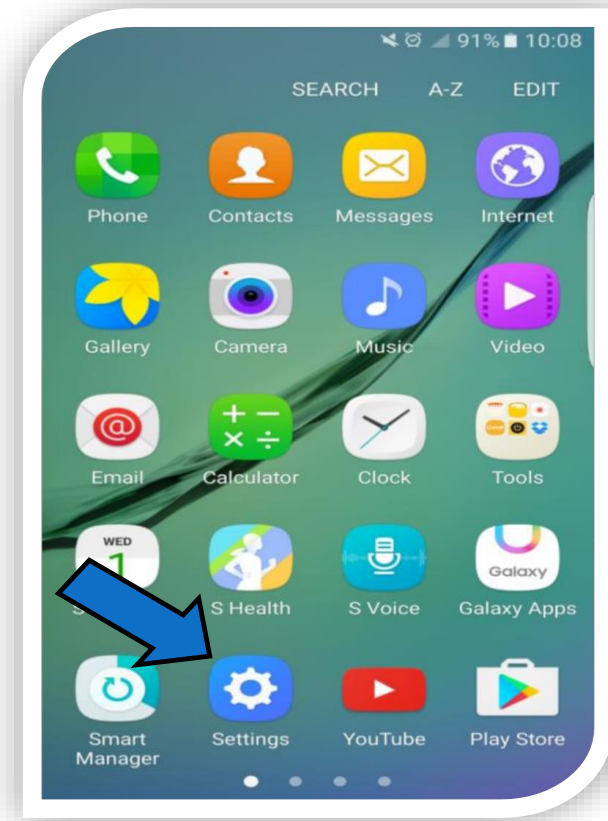

UNI-WIFI ON ANDROID PHONE

- Then go to **Wi-Fi**

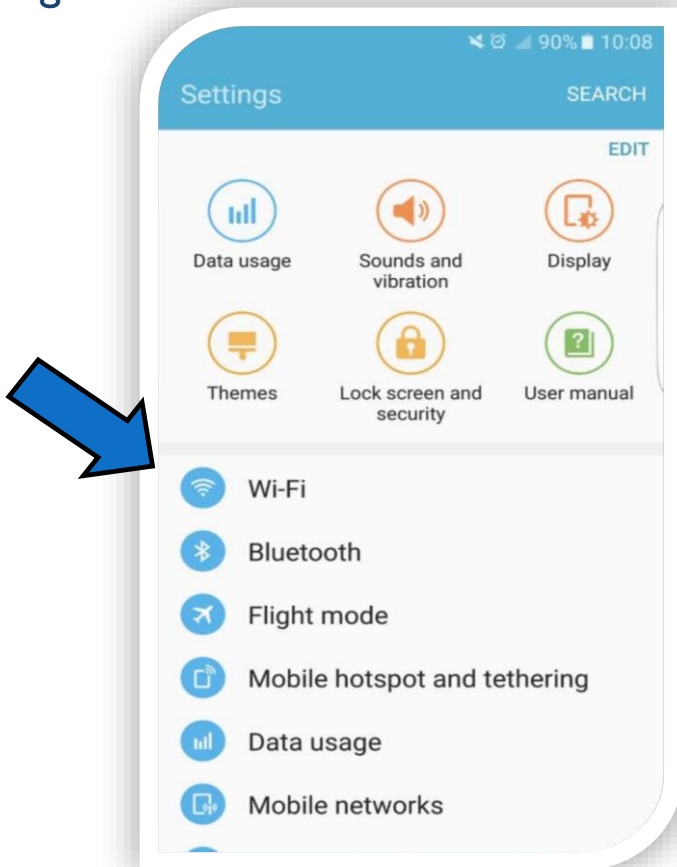

- Then select **Uni-WiFi** from the list of networks available

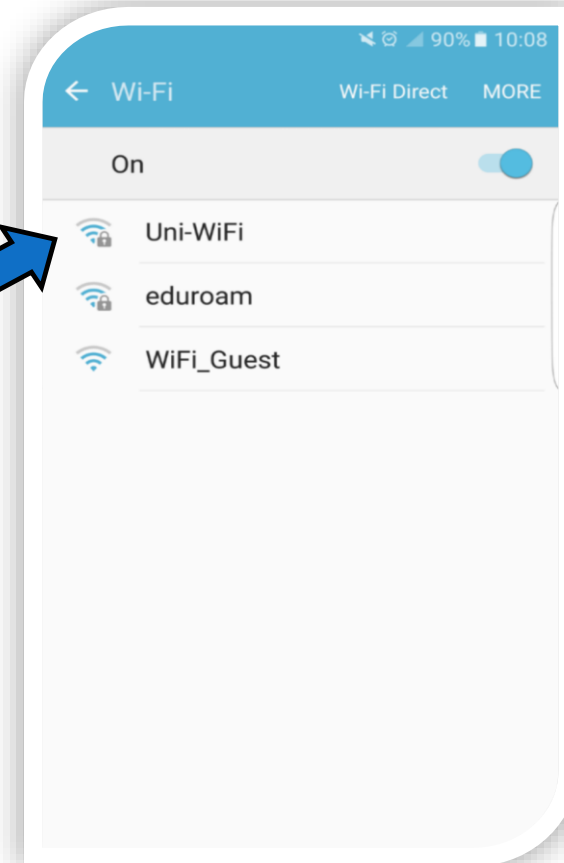

- Ensure your **Wi-Fi** is on, like so...

UNI-WIFI ON ANDROID PHONE

- You will be prompted to input your **Identity**, this is your University username e.g. UI234567 and **Password**, this is your University password.
- Enter phase 2 authentication as **MSCHAPV2**. You don't need to specify a certificate
- Then click **Connect**, once done

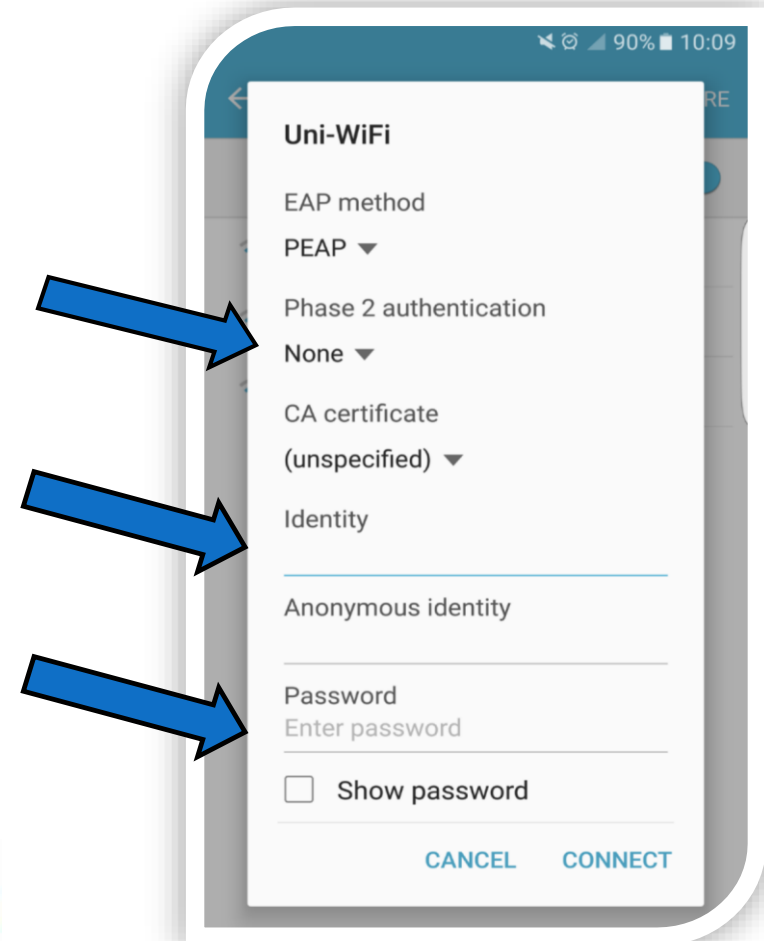

UNI-WIFI ON ANDROID PHONE

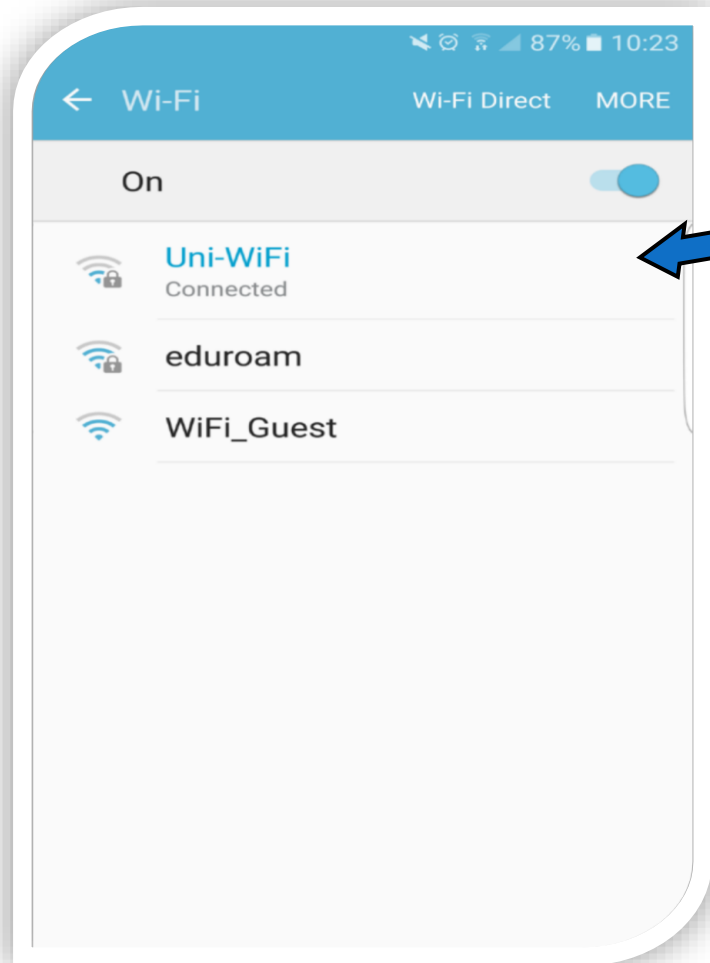

You are now connected!

You should now be connected to Uni-WiFi and have access to the internet